

# DENON®

## DHT-S316

HOME THEATER SYSTEM

# Quick Start Guide

Kurzanleitung / Guide de démarrage rapide / Guida di Avvio Rapido /  
Guía de inicio rápido / Snelhandleiding / Snabbstartsguide /  
Краткое руководство пользователя / Skrócona instrukcja obsługi

## Read Me First....

Bitte zuerst lesen... / Lisez-moi en premier.... / Nota preliminare.... /  
Lea esto primero.... / Lees mij eerst... / Läs detta först... /  
Прочитайте в первую очередь... / Przeczytaj to najpierw....

ENGLISH

DEUTSCH

FRANÇAIS

ITALIANO

ESPAÑOL

NEDERLANDS

SVENSKA

РУССКИЙ

POLSKI

# Welcome

Thank you for choosing a Denon TV Sound system.  
This guide provides step-by-step instructions for setting up  
your TV Sound system.

# Before You Begin

## What You Need

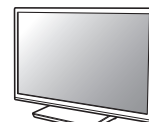

TV



- These drawings are for illustrative purposes only and may not represent the actual product(s).

# What's In the Box

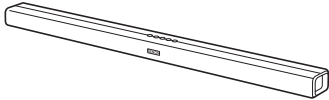

Soundbar



Subwoofer



Quick Start Guide

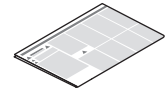

Safety Instructions

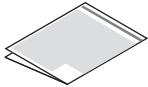

Cautions on Using Batteries

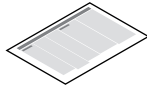

Notes on radio

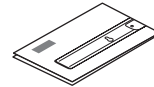

Wall mount template



Power cords

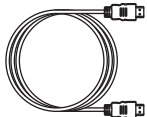

HDMI cable

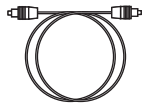

Optical digital cable



Wall mount spacers



Remote control unit  
(RC-1230)



R03/AAA battery

## Installing batteries in the remote control unit

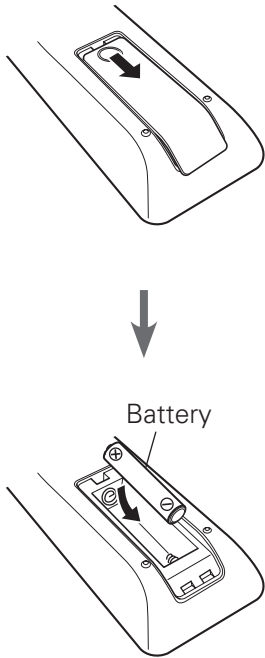

# Setup

There are six steps to the setup process.

- 1** Placing the Soundbar
- 2** Placing the Subwoofer
- 3** Connecting the Soundbar to TV
- 4** Connecting the power cords to AC outlet
- 5** Using the Soundbar for TV sound
- 6** Using the Soundbar for Bluetooth music streaming

# 1 Placing the Soundbar

Place the Soundbar in front of the TV.

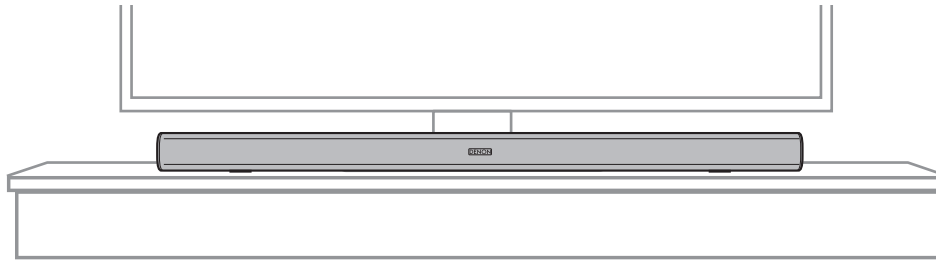

- The Soundbar can be wall-mounted using the integrated keyhole mounts. Refer to the wall mount template in the PE bag which contains multiple documents. (Same as this Quick Start Guide bag.)
- If you want to install your Soundbar on a wall, please refer to the Owner's Manual for mounting instructions or contact your Denon dealer for assistance.

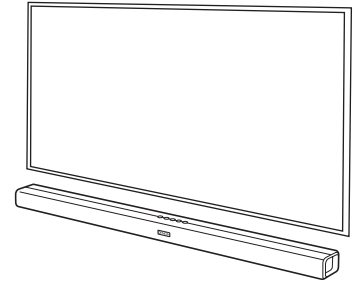

## 2 Placing the Subwoofer

Place the Subwoofer on the floor near the Soundbar.

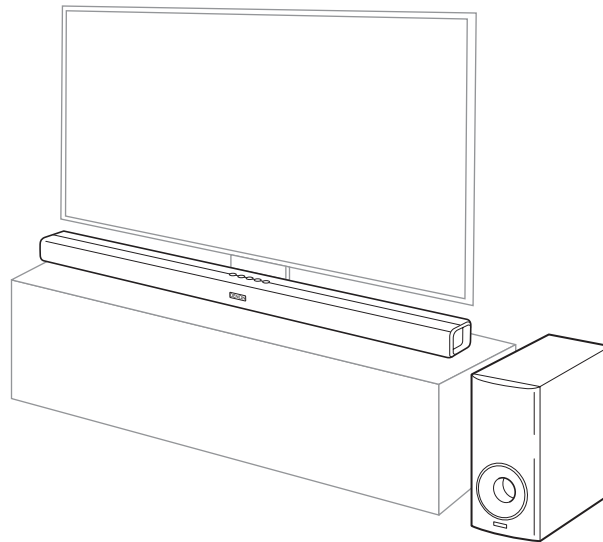

### 3 Connecting the Soundbar to TV

For TVs with ARC (Audio Return Channel) support, connect the Soundbar to the TV with the included HDMI cable.

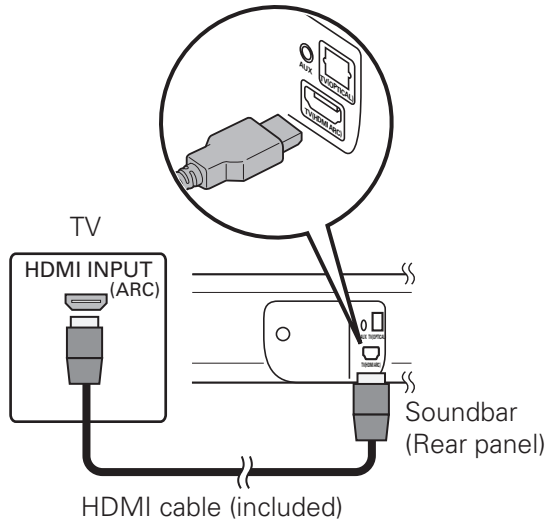

- If the TV does not support ARC, connect it to the Soundbar using the included HDMI cable and optical digital cable.

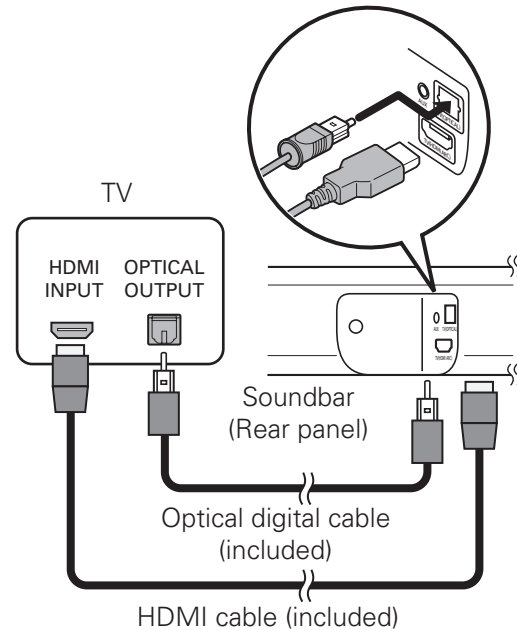

## 4 Connecting the power cords to AC outlet

Connect the included power supply cords to the Soundbar and Subwoofer, and insert the plugs into an outlet.

- Turn on the Soundbar and the LED on the back of the Subwoofer will change from off to green.

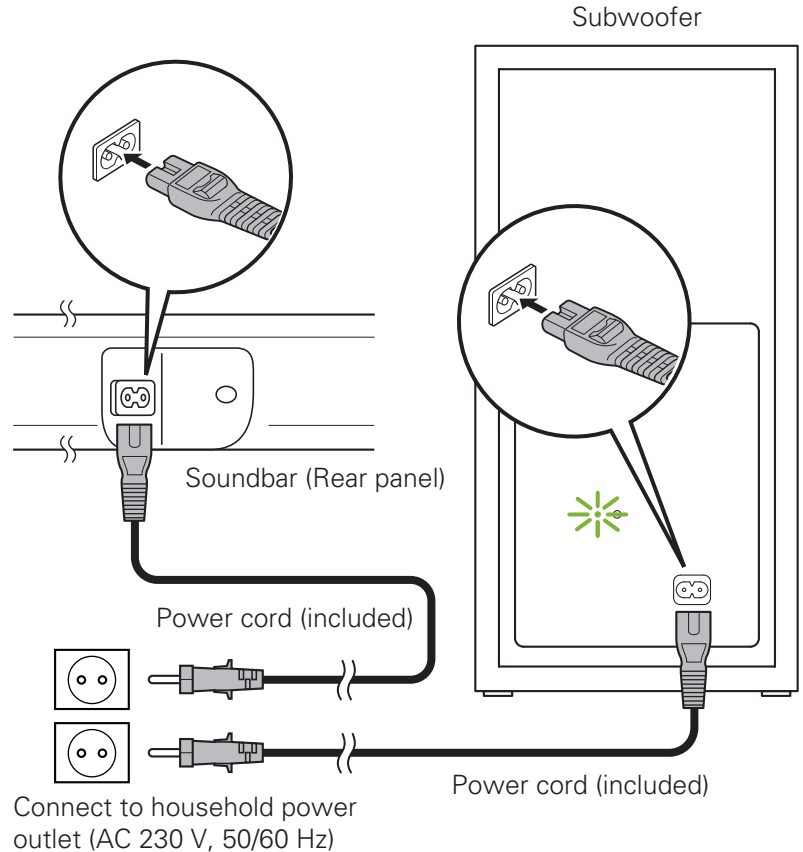



## 5 Using the Soundbar for TV sound



Turn on your TV.



- If you hear audio coming from TV's internal speaker, make sure TV speaker off or min volume.

## 6 Using the Soundbar for Bluetooth music streaming

Before you can stream music from your Bluetooth device to the Soundbar, you must first “pair” the Soundbar and your device.

- ① Press the  (Bluetooth) button on the Soundbar (or remote control unit) until the Bluetooth LED blinks in blue.  
To pair additional devices, press and hold the  (Bluetooth) button to automatically enter pairing mode.
- ② Go to the Bluetooth settings on your device and make sure Bluetooth is turned ON.
- ③ Select “DHT-S316”.
  - The Bluetooth LED turns blue to indicate that the Soundbar is being paired with your Bluetooth device.

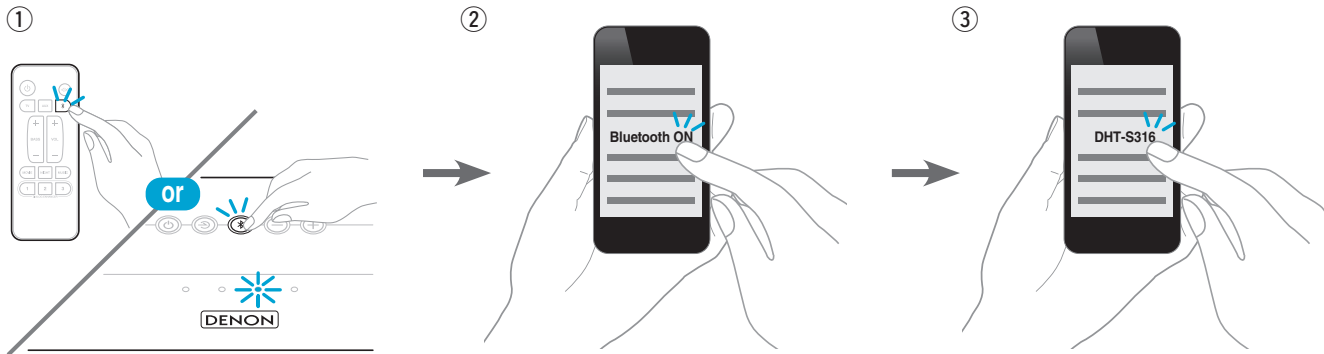

# Owner's Manual

- For more information, visit [www.denon.com](http://www.denon.com)
- Refer to the Online Manual for other functions information and operation procedure details.  
[manuals.denon.com/DHTS316/EU/EN/](http://manuals.denon.com/DHTS316/EU/EN/)

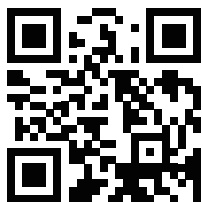

Online Manual



**DENON®**  
[www.denon.com](http://www.denon.com)

Printed in China 5411 11698 00AD  
Copyright © 2018 D&M Holdings Inc. All Rights Reserved.